



## INFO SESSION



## Merimbula Public School Stage 2 Skiing and Snow Excursion

### Information for Parents and Answers to Questions Received

#### 1. Why are we having a Skiing/Stage 2 Overnight Excursion?

- As this is the first time in many years that Stage 2 teachers have wanted to offer an excursion. We cannot run overnight, or any excursion, without teachers volunteering their time to coordinate, complete bus and venue quote applications, liaise with the venue, complete risk assessments and permission notes etc all in their own time.
- All activities on offer at our school ONLY run as teachers volunteer to coordinate them, and are willing and able to do so (mostly in their own time).
- Many other schools in this area offer a Snow/Skiing Excursion. We thought that offering this option would be one more way we could broaden the curriculum and opportunities for our students too. *For example:*
  - Wolumla PS – Year 6 Excursion 2017 and 2018 (4 days).
  - Towamba PS – K-6 Excursion 2017 (3 days); no bus; parent/staff cars; only Kindy parents went/slept over; cabin accommodation at Alpine Adventist Village Jindabyne.
  - Tathra PS – Stage 3 Jindabyne Sport and Recreation Centre 2017 (They do Berry Sport and Recreation Centre in 2018); 4 nights for \$648 after fundraising (was \$742); Stage ran an Easter Raffle (-\$16.90 each), a Chocolate Drive (-\$800), P&C donated \$1000 towards the bus.
- In our 2017 Facebook surveys, parents indicated that they wanted more sport options.
- This is one way of the students addressing PD/H/PE outcomes and meeting the 150 min of sport/physical education a week we are required to ensure.
- Not many students have been to the snow by Years 3 and 4. In the past many students have complained that the excursions include activities that they have already done (eg attendance at venues in Canberra, that's why we are no longer having a Canberra excursion).

#### 2. Why was there no notice to parents/carers earlier?

- When the teachers suggested that they would like to offer a skiing excursion, and were encouraged to enquire about venue availability, there were only two venues and one set of dates that both were available. Tentative bookings were required to be made by the week's end or we could have lost the opportunity altogether. The Alpine Adventist Village and the Sport and Recreation Centre in Jindabyne were the only two venues available, both on September 10-12. The Sport and Rec. centre was chosen as it also hires out equipment and clothing and the rooms are not isolated cabins. The Sport and Rec. Centre also ensure all staff in all jobs/roles have a WWCC, and that they are teachers and/or have a Cert. 4 in Sport and Recreation.

### 3. Why were the parents not informed before the children?

All school communication is sent to parents via notes. It is school practice that the notes/newsletters are discussed before they go home so that children are reminded to give messages to their parents. Parents who attended the last (April) P&C Meeting were informed before the students. In the cases of large/whole-school events, the P&C are usually informed first (if time permits). No parent/s have ever questioned why students have been informed first in the past.

### 4. Can parents attend as volunteers?

We asked the venue. They said no, and that they had never been asked such a request before. In the case of Towamba PS they had more private travel/accommodation due to the smaller size of the group.

### 5. Will there be a Year 5 and 6 excursion too? Why are we having an excursion that costs so much when there are costly excursions in Years 5 and 6?

While we hope Year 5 and Year 6 excursions will be offered, nothing is guaranteed. Teachers need to volunteer. The school also requires additional teachers to be prepared to step in as back-ups (who know the children, not all casuals) should a teacher not be able to attend due to illness, leave, family/out of school commitments, pregnancy etc.

### 6. Why does it cost so much? What are we paying for? What is the breakdown?

- We are NOT paying for staff. Four teachers will be attending with the four classes. For safety/supervision in overnight activities MPS requires the ratio to be 1:20 staff to students. Mr Morris is planning to attend as some of his students are. The remaining students will be in the other Support Classes/Home Classes. Ms Hulme will also be attending. Other excursions which require casuals/class teacher replacements usually cost another \$500 per day per staff member (this excursion could have cost an additional \$3000 if Mr Morris and Ms Hulme did not volunteer to attend).

Activity Per Student	Cost Per Student
Outdoor Education Program <ul style="list-style-type: none"><li>- 2 nights accommodation</li><li>- Food (3 dinners, 2 breakfasts, 2 lunches)</li><li>- Sport and Rec. Teachers</li><li>- 2 day lift/lesson pass @ Perisher</li><li>- Professional Graded Lessons with Perisher Snow Sports</li><li>- Private Meeting and Storage Areas on the Snow</li><li>- Ski Equipment Hire</li><li>- Transport to/from Ski Tube Terminal &amp; Ski Tube Ticket</li><li>- Evening Recreation Activities Hosted by Sport and Rec. Centre</li><li>- Neck Warmer and Drink Bottle for each student</li></ul>	\$619.05 (school will claim back \$50.43 GST on students' behalf) SO= <b>\$568.62</b>
Bus Travel	<b>\$50.50</b>
Morning Tea 11/9 and 12/9 as an Extra	<b>\$5.00</b>
<b>TOTAL</b>	<b>\$624.12 (rounded up to \$625)</b>

**The school has already paid/saved:**

Activity Per Student	Cost Saved Per Student
Outdoor Education Program	<b>\$50.43 GST Claimed Back per child</b>
\$619.05 per additional staff to reduce ratios (so \$1238.24 divided by 100)	<b>\$12.38 per child</b>
Not charging for additional staff	<b>\$30 per child</b>
<b>TOTAL</b>	<b>\$92.81</b>

**If we were to attend with our child on the weekend:**

**Activities:**

**Lessons:**

**Weekend prices**

Catered programs per night	High season 1 January to 30 April 2018 1 July to 31 August 2018	Low season 1 May to 30 June 2018 1 September to 31 December 2018
Adult (18 years and over)	\$110	\$101
Child (5 to 17 years)	<b>\$85</b>	\$74
Child (4 years and under)	Free	Free

Activities can be included for an additional cost of \$525 per day or \$265 per half-day for groups of 20 to 30 people with an instructor. Prices are subject to change without notice.

**3 Day Child Ski Lesson Options**

**Lesson Benefits**

Learning to ski can be a great experience with the right instructor helping you to learn quickly. Gain confidence with more individual attention, refine your skills and tackle new and more challenging terrain. Learn while having fun!

- Safety, fun and learning
- Maximise your time on snow with the help of our professional instructors
- Build confidence on terrain suitable to you

**3 HOUR GROUP LESSON**

PERISHER VALLEY ⓘ

9AM

CHILD 5-14 YEARS	FULL PRICE	BUY EARLY & SAVE ⓘ	
Lift, Lesson & Hire	<b>\$416</b>	\$224	46%
Lift & Lesson	\$296	\$224	24%
Lesson Only	\$186	\$157	16%

Choose the pass that suits you and start saving:

**Annual pass options**

1-year pass

2-year pass

Link to purchase

**All Parks Pass**

For all fee-collecting parks in NSW, including Kosciuszko National Park.

**\$190**

**\$335**

**National Parks Entry Pass To The Snow:**

- Plus: petrol, parents' accommodation, gear hire, tyre chains, car wear/tear, before/after school care \$70 a day (not including 6pm-6am).
- *Therefore whilst this excursion is as expensive as the Stage 3 ones, it is better value for money and like the Stage 3 excursions it is not compulsory. Not every student in a grade/class attends each overnight excursion.*

## **7. Will students need spending money?**

- No. They will not get the opportunity to shop or go to a shop.

## **8. Do the kids have to take a sleeping bag or is all bedding provided?**

- Linen (top sheet, bottom sheet, pillow case and a towel) needs to be supplied by each student. Alternately we can hire these for \$15 per student. On past camps students have taken all linen needed.
- Comforters and blankets are provided.
- Hire of linen would cost an additional \$15 per student, but could be covered by fundraising if wanted.

## **9. What if they get hungry/need a drink in the night?**

- With bookings of 100 students we get free use of the lounge room and conference rooms. This will also include 24 hour access to tea/coffee/hot milo (that will be supervised/organised by our staff).
- We have ordered additional morning tea for the students.

## **10. Can fundraising reduce the cost?**

- Yes. If so, we need to set a target early as giving refunds to parents/carers (some have already paid in full) is a timely process for our administration staff and those waiting on refunds.
- Taking \$25 off the excursion cost would mean we would have to raise \$2500 (if 100 students attend). We can aim for \$2500 and if 50 attend, the excursion would cost \$575.
- The Stage 2 and 3 Excursions usually aim for and raise \$4300. This year's Mini Fete was the most successful one ever! More money was spent and raised. The Year 5 and 6 excursion fundraising targets (\$4300 total) have already been met. Other planned fundraisers will now be hosted by the Stage 2 staff.
- Possible upcoming fundraisers that Stage 3 were going to have:
  - 5c coin drive = \$700
  - Term 2 and Term 3 Discos = \$1000
  - Mufti Day Week 4 = \$300
  - Ice Cream Day Week 8 = \$400
  - TOTAL = \$2400 (less \$25 per child, or \$50 if one bus)
- Possible fundraisers Stage 2 staff are interested in holding:
  - Clubs Grant (application by T.Stafford being submitted for \$2500)
  - Trivia night (S. Doherty interested in coordinating it with assistance, could raise \$2K)

## **11. What if it is too expensive for some students? Families?**

- Last year 12 students were subsidised to be able to attend the Stage 3 Excursion (various amounts depending on their application). The school budgets for student assistance annually.
- The school also supports families in the following ways:
  - Getting breakfast club grants/donations (\$1-2K annually);
  - Online maths, spelling, reading subscriptions and programs for students (with accompanying text books for spelling and for some handwriting (\$20K annually);
  - Free music tuition/band (many public schools charge per term);
  - Student Assistance (\$5285 annually);
  - Visiting performances/Jigamy subsidy (\$3K annually);
  - Recorder excursion attendance / sports team travel & accommodation for staff (\$5K annually);
  - Representatives at State Level subsidies (\$1K annually).

## 12. Which MPS teachers are going?

Provided the staff are well, and still at the school....there are a number of options. This will be confirmed closer to the excursion. All staff attending can ski (to different levels).

### 100-120 Students:

Ms Michelle Hulme (Coordinating Executive Teacher)

Mr Craig Morris

Mr Shane Doherty

Mrs Amanda Fowler

Miss Natasha Sconfienza

Mr Ben Kirk (for Miss Stafford)

Miss Stafford will not be attending the Snow Excursion (despite her really wanting to go and having seen the benefits of such an excursion both as a teacher and ski instructor) as she will be too close to her maternity leave at the time. Miss Stafford will be teaching Mr Kirk's class.

### 80-100 Students (Anticipating some Stage 3 children will also be attending):

Ms Michelle Hulme (Coordinating Executive Teacher)

Mr Craig Morris

Mr Shane Doherty OR Mrs Amanda Fowler

Miss Natasha Sconfienza

Mr Ben Kirk (for Miss Stafford)

- Miss Stafford Teach 6K
- Year 4 Teacher teach Stage 2
- If a lot of 6K attend they may be split into the classes where Stage 3 students have come out of.

### 50-80 Students (Anticipating some Stage 3 children will also be attending):

Ms Michelle Hulme (Coordinating Executive Teacher)

Mr Craig Morris

Miss Natasha Sconfienza

Mr Ben Kirk (for Miss Stafford)

- Miss Stafford Teach Year 3 / Mr Doherty Teach Year 4 / Mrs Fowler Teach 6K.
- Arrangements would depend on which classes the remaining children are from.
- As with any sport/extra-curricular activity, classes are split if a teacher is attending. This may be the case if student attendance numbers are low in some classes/grades.

### <60 Students/1 Bus (Anticipating some Stage 3 children will also be attending):

Ms Michelle Hulme (Coordinating Executive Teacher)

Mr Craig Morris OR Mr Ben Kirk

Miss Natasha Sconfienza

- Arrangements would depend on which classes the remaining children are from.
- As with any sport/extra-curricular activity, classes are split if a teacher is attending. This may be the case if student attendance numbers are low in some classes/grades.

### 13. What are the sleeping arrangements? Can we insist certain children share the same room and are only with other children of the same year group?

- Accommodation arrangements would depend on the numbers attending.
- As with ALL past excursions, teachers group students with friends.
- Rooms are gender-based.
- Rooms are stage-based.
- Rooms will be grade-based if possible.
- If rooms are Stage-based (ie A Year 3 and Year 4 Room) the students who know each other (ie through sport, 2017 composite classes, after school activities) will be placed together.
- We will be told how many rooms we have based on the final numbers we submit.
- Most rooms will have to be filled so that all students have a teacher on their floor.
- If Year 3 and 4 students have to share, there will be no “odd one out”. ie: The room may have 4 Year 3 and 4 Year 4 boys who know each other/play together.

#### Room Layout:

Jindabyne Sport and Recreation Centre has catered accommodation for up to 436 people. Our dormitory-style lodge accommodation sleep eight people per room with shared bathroom. There is a common dining room, a laundry onsite and we can accommodate people with a disability. Weekend catered programs are available for groups and include accommodation and three meals per day Friday dinner to Sunday lunch.



#### Milton lodge

- One lodge
- Accommodation for up to 44 people
- Five bedrooms, each with four double bunks
- Two staff bedrooms with ensuite
- Two student bathrooms
- Lounge room with digital TV
- Air-conditioned
- Meal packages available
- No cooking facilities
- Wheelchair-accessible lower level
- Drying room with washing machine and dryer.

#### JSR\_Milton\_Lodge.png





## Student lodges

- Six lodges at the Centre
- Accommodation for up to 34 people
- Four bedrooms, each with four double bunks
- Two staff bedrooms, each with one bed
- Two student bathrooms and one staff bathroom
- Lounge room with digital TV
- Meal packages available
- No cooking facilities
- Drying room with washing machine and dryer.

## JSR\_Student\_Lodges.png



### 14. If the school has to open the trip to other schools/stages, how will parents be notified of the ages of kids going? And, can parents who have already paid a deposit, get a refund if they are not happy?

- If we do not get 100 of the 116 Stage 2 students attend (or 50 if we decide to take 1 bus), we will be inviting Years 5 and 6 students (but not students from other schools).
- Years 5 and 6 students range between 10-12 years of age.
- The number of students attending, and from which stages, will be shared in an upcoming newsletter. Obviously this could change if students move schools, get injured and cannot attend etc.
- Parents not comfortable with older students attending should choose not to send them from the outset. All bus seats will be filled as to not cost the school money.
- We currently have students in Years 5 and 6 attending Music Camp with students up to Year 10. Students are offered to attend a range of inter-school, cross-stage excursions and camps in the coming years. If you do not want your child to be involved, tell them they can't.
- Deposits will not be refunded unless the child's spot in the excursion is filled by someone on a wait list.

### 15. If, due to low numbers, the price goes up after the deposit is paid - can those parents get a refund?

- The price will not go up. The school will absorb any shortfall however there should not be any.
- If at any time a parent chooses to withdraw their child (due to illness, moving schools, change of mind etc) all amounts of your deposit will be refunded if your child's place can be filled (If the child's place cannot be filled \$100 of the deposit will be lost for all reasons except change of mind. Last minute changes of mind will forfeit payment).
- If a child is withdrawn from the excursion due to the school making the decision (ie poor behaviour, the child is on behaviour monitoring, is suspended or has been suspended within the term) the school will refund all money and the school will lose out (in the interest of the safety of all involved).

### 16. What are the clothing requirements? Will this be mandatory? Who will ensure they put the necessary clothes on (e.g. thermals are usually needed)? If kids have not packed/do not have the necessary clothes/have not put them on, will they be prevented from skiing/going to the snow?

- As with the last Stage 2 camping excursion, all bags were brought in to the school early (ie on the Thursday before) so that items could be checked and adequate clothing/safety items were packed/obtained.
- The ski instructors (also noted in their Risk Assessment) check socks and boots each morning prior

to lessons for fitting and adequate wearing of items.

- Clothing is checked by the venue supervisors and teaching staff prior to children leaving the venue each morning.
- Thermals are not needed. They are optional. Some staff have never worn them. In fact, they can cause you to sweat and get wet/cold under your ski gear.

**17. Are helmets and goggles provided as part of the equipment hire?**

- Helmets are part of the equipment hire package.
- Goggles are not provided. Some staff have multiple pairs they are willing to lend. We will send out more information about this soon, asking for donations and loans. Parents/carers should also ask friends. St Vincent DePaul in Bega also has a large area of second hand ski gear.
- Other items needing to be hired can be ordered at a later date, such as:

<b><u>JACKET and PANTS</u></b>	
1 Day	\$14.25
2 Day Consecutive	\$20.35
3 Day Consecutive	\$26.45
4 Day Consecutive	\$32.55
5 Day Consecutive	\$38.65
<b><u>GLOVES / GOGGLE per item</u></b>	
2 Day Consecutive	\$7.15
3 Day Consecutive	\$9.15
4 Day Consecutive	\$11.20
5 Day Consecutive	\$13.25

<https://sportandrecreation.nsw.gov.au/facilities/schools/parent>

**2018 HIRE PRICES**

**18. What insurance and ambulance cover is it recommended (or required?) parents have for their children?**

- The school has ambulance cover.
- Parents/carers will be asked to supply any private health cover information on the Medical Form/Permission Note at a later date.
- This excursion will have so many safety precautions. It will be treated like any other school day in terms of illness and injury.

**19. Has anyone checked with the lodge at Jindabyne if all staff our kids may come into contact with have a working with children check?**

- Yes we have checked, and all staff at the lodge do have WWCCs.

**20. Can students who are on leave attend (ie students in Distance Education/Enrolled at another school during the Ski Season Terms)?**

- No. Only enrolled students who are attending Merimbula PS at the time, and are not on Behaviour Monitoring/Suspended/have been suspended in 10 weeks can attend (in accord with our Discipline Policy).

**21. When skiing/on the snow what will the supervisor/instructor to student ratio be?**

- It depends on the number of children attending.
- This will also depend on the level of the skiers and locations where they will be skiing.
- There will always be one MPS staff member with each group and one Perisher Instructor. The Sport and Rec. Camp staff will be placed with groups as to lower the ratio.



**22. What plans are in place for medical emergencies, failure of equipment (or mobile phones with no reception), extreme/unpredicted weather conditions, a lost child?**

- Staff and instructors have phones that have reception in Perisher. We have all been there and use them.
- Two staff members will be with each group as to have one able to go to a lift/support personnel if needed.

**23. What activities are planned on all the days (inc ski lessons) and approx times?**

**A Typical Ski Day**

<b>Early Ski</b>		<b>Late Ski</b>	
<b>6:30am</b>	Breakfast – please inform staff member on breakfast of sick kids who can't go to the snow	<b>7:30am</b>	Breakfast then free time – please inform staff member on breakfast of sick kids who can't go to the snow
<b>7am</b>	Buses leave for Perisher Students need to put their boots on at Bullocks Flat before getting onto Ski Tube	<b>9am</b>	Buses leave for Perisher Students need to put their boots on at Bullocks Flat before getting onto Ski Tube
<b>8:30am</b>	Lessons ( 2 hours )	<b>10:30am</b>	Lessons ( 2 hours )
<b>10:30am</b>	Names marked off then free ski time	<b>12:30pm</b>	Names marked off.
<b>12 noon</b>	Lunch	<b>12:45pm</b>	Lunch
<b>12:30pm</b>	Free Ski Time	<b>1pm</b>	Free Ski Time
<b>2:00pm</b>	Name marked off at hut	<b>2:30pm</b>	Names marked off at hut
<b>2:30pm</b>	Ski Tube from Blue Cow to Bullocks Flat, bus to Jindabyne then free time supervised by teachers	<b>4:20pm</b>	Ski Tube from Blue Cow to Bullocks Flat, bus to Jindabyne then free time supervised by teachers
<b>3:30pm</b>	Ski Hire Issues	<b>5:15pm</b>	Ski Hire Issues
<b>5:30pm</b>	Dinner	<b>6pm</b>	Dinner

**Students** : Please help by ensuring you are on time for meals, buses, lessons and getting your name marked off. This is crucial, thanks. Groups that are slow in doing this will need to have free ski times reduced.  
Sport and Recreation staff will allocate areas for their groups to be marked off.

**24. How will you determine the ski experience of each child? What happens if a child is an intermediate or advanced skier and no other children are (or you don't have enough children to fill those lessons)?**

- More questions will be asked of parents in upcoming notes (ie like we do at the swimming carnival).
- The instructors will also adjust groups/assess students as required.

**25. What is the protocol if a child no longer wants to ski, is cold and miserable, is sick and can't ski?**

- Like any other school day/school lesson, children will be encouraged to take part. They will also be expected to take part.
- If students refuse to take part, or they are sick, or excused for misbehaviour/suspended, their parent/caregiver will be required to collect them. Parents will be notified ASAP.

**26. Overnight how far away will the supervising teacher be from our kids? We are talking about 8 year olds, some of whom have never had sleepovers before.**

- See the map:

## JSR\_Student\_Lodges.png

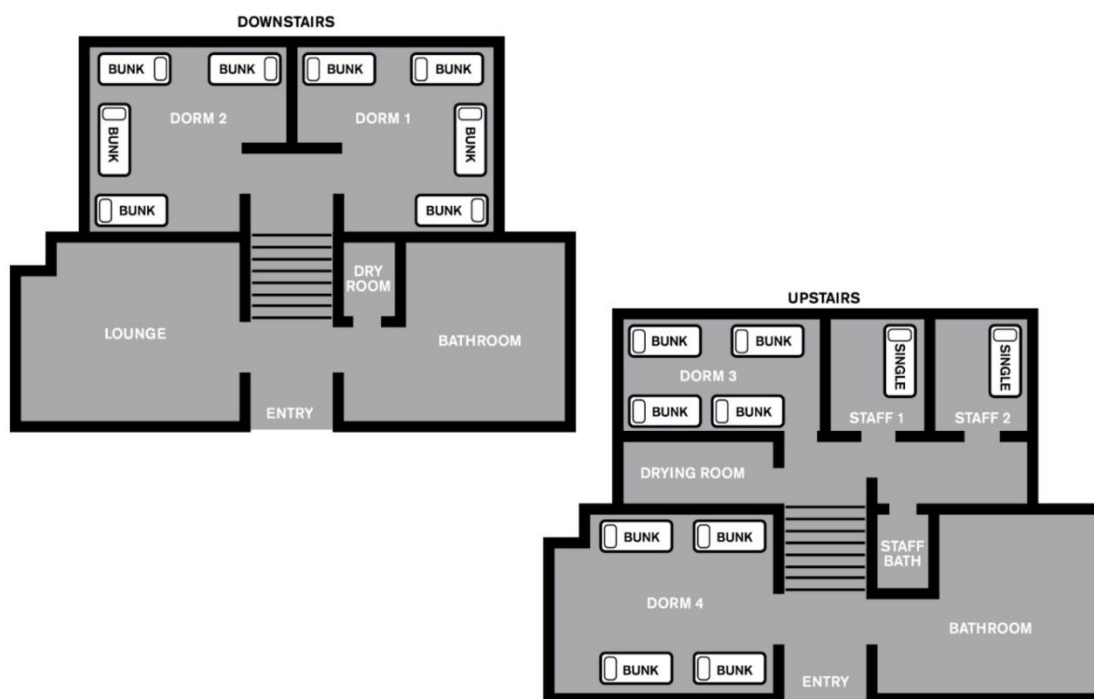

**27. What will happen to the kids who don't attend the camp? Will they be placed in other year level classes or will a Stage 2 class be running and who will be teaching it for those 3 days?**

- This depends on how many Stage 2 students do not attend (as well as how many 6K students attend if any).

**28. During the actual ski time will the kids always be part of a controlled group run by the resort or will there be free ski time? If there is free ski time who will supervise that, in what numbers and how?**

- At all times students will be in a 'controlled' / supervised group.
- During "free ski time" the students will always be with an MPS teacher and they will only ever go to the locations where they have skied on the day.

**29. Has anyone checked with the ski resort if all of the instructors have a working with children check?**

- Yes we have, and yes they do. It is law.
- In addition, an MPS staff member will always be with each group.